



72 X 72 / 96 X 96mm

**Features :**

- True RMS Measurement
- Scale Interchangeability
- Non Linear Scale
- Knife Edge Pointer
- Grey Lexan Housing
- Panel Mounting

**Scale and Pointer**

Pointer	Knife - edge pointer
Pointer Deflection	0 to 90°
Scale Characteristics	Non Linear
Scale Length	AM-I-2 : 63mm AM-I-3 : 97mm

**Electrical Specifications**

Measured Parameters	AC Current
Measuring Current Range	0 to 5A (CT Secondary) Suppress scale : 0 to 5 / 30A (CT Secondary)
Overload Capacity Continuously	1.2 times rated Current
Overload Capacity Short Duration	10 times of rated current upto max 5 sec
Power Consumption	Max 0.8VA
Frequency	50 - 60 Hz
Accuracy	Class 1.5
Over Range	6 times nominal current (for suppress scale)
Dielectric test	2 kV AC for 1 Minute

**Mechanical Specifications**

Mounting	Panel Mount
Weight	AM-I-2 : 0.16 kg AM-I-3 : 0.22 Kg

**Environmental Specifications**

Operating Temperature	0°C to +60°C
Storage Temperature	-20°C to 60°C
Relative Humidity (non - condensing)	upto 75%

**Dimensions (All are in mm)**

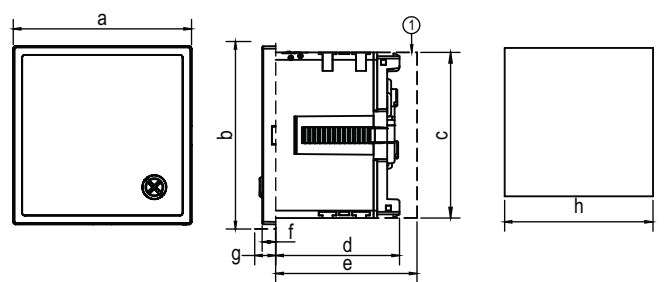

Product	72x72	96x96
Dimensions (in mm)		
a	72	96
b	74.50	98.50
c	67	90.50
d	50	50
e	60	60
f	5.50	5.50
g	8	8
h	68	92

**Optional parts :**

- 1 - Back Cover
- 2 - IP65 : Cover for all type of AM series

**Terminal Connections**

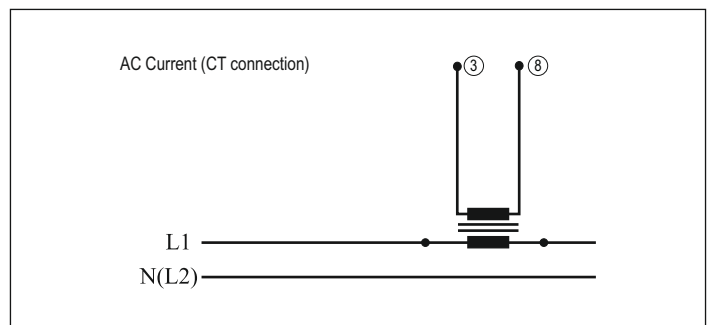

Compliance

Applicable EMI / EMC Standards		
Product Standard : IEC 60051-2		
Category		Standards Compliance
ESD Immunity	IEC 61000-4-2	Contact Discharge : 4kV (Criteria B) Air Discharge : 8kV (Criteria B)
Surge Immunity	IEC 61000-4-5	0.5kV (for L-L) (Criteria B)
Radiated Susceptibility	IEC 61000-4-2	800MHz to 1GHz (10V/m) (Criteria A) 1.4GHz to 2GHz (3V/m) (Criteria A) 2GHz to 2.7GHz (1V/m) (Criteria A)
Conducted Susceptibility	IEC 61000-4-6	3V (Criteria A)
PFMF	IEC 61000-4-8	30 A/M (50Hz, 60Hz) (Criteria A)
Voltage Dips and Interruptions	IEC 61000-4-11	<b>VDI</b> : 0% during 1 cycle (Criteria B), 40% during 10 / 12 cycles (Criteria C) 70% during 25 / 30 cycles (Criteria C) <b>Short Interruptions</b> : 0% during 250 / 300 cycles (Criteria C)
Electrical Fast Transient	IEC 61000-4-4	1kV (Criteria B)

Ordering Information

Product Code (Meters Without Dial Plates)	Certification
AM-I-2-5A-WD-CE-RoHS	CE
AM-I-2-5A-6S-WD-CE-RoHS	CE
AM-I-3-5A-WD-CE-RoHS	CE
AM-I-3-5A-6S-WD-CE-RoHS	CE
AM-I-2-5A-WD	---
AM-I-2-5A-6S-WD	---
AM-I-3-5A-WD	---
AM-I-3-5A-6S-WD	---

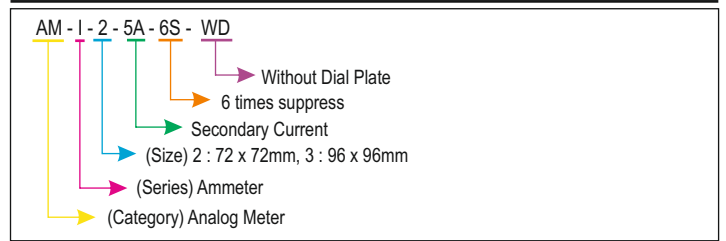

Product Code (Only Scale Dial Plates)	Certification
SCL-AM-I-2-X/5A	---
SCL-AM-I-3-X/5A	---
SCL-AM-I-2-X/5A-6S	---
SCL-AM-I-3-X/5A-6S	---

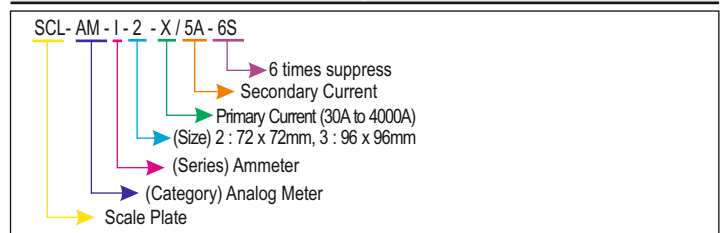

Available Scales (X) are 30, 40, 50, 60, 75, 80, 100, 125, 150, 200, 250, 300, 400, 500, 600, 800, 1000, 1200, 1250, 1500, 1600, 2000, 2500, 3000, 3200, 4000 Ampere.